

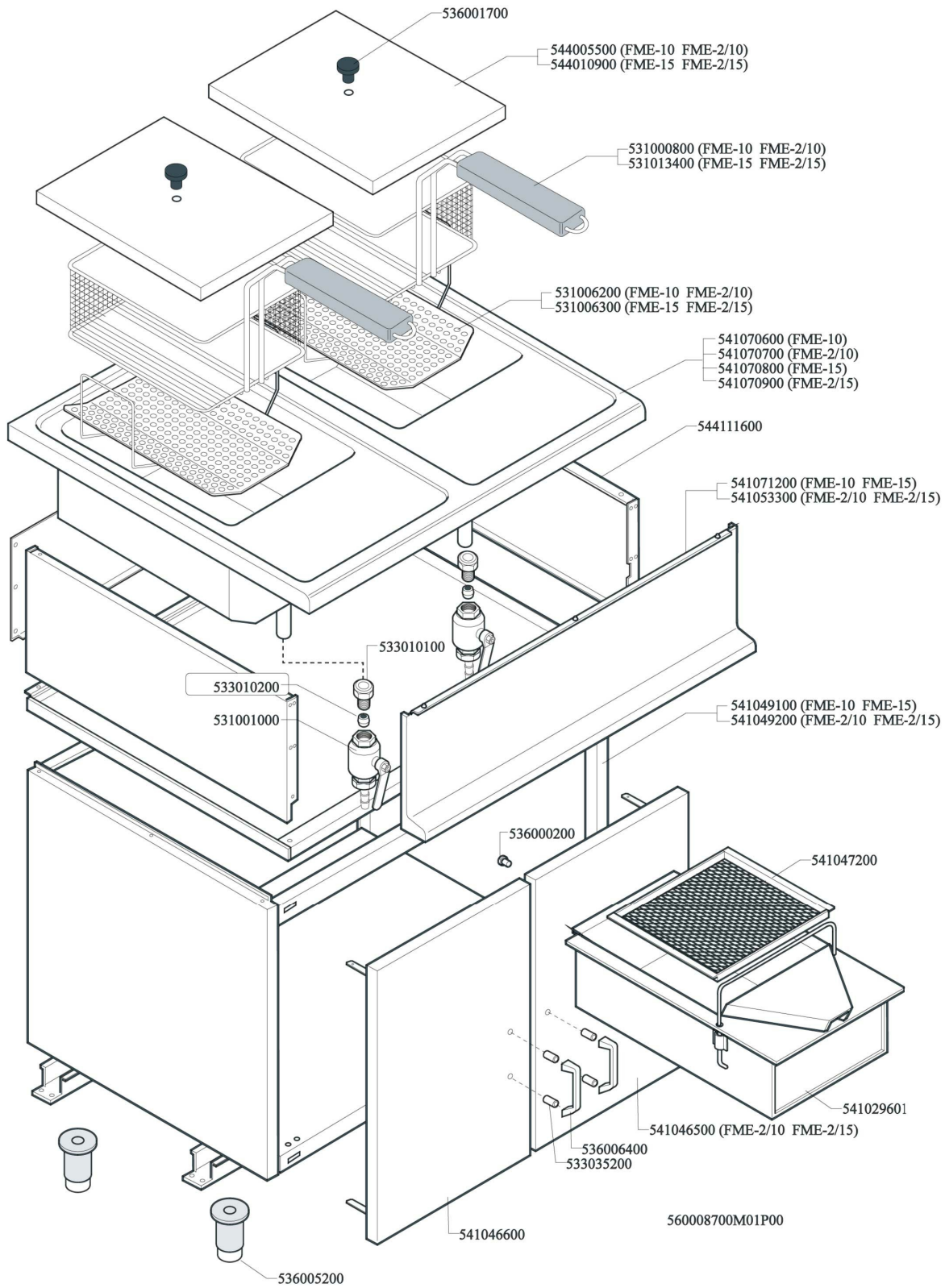

FME-2/10  
Tav. 560008700M01P00





## FME-2/10 - FRIGGITRICI FME-2/10

Codice	Descrizione
539016400	DISC.64.FQ-E R. (110,190°)
536013800	MANOP.Ø70 PEL Ø06X5 SEDE PERP.
537000200	COMM.1 POS.3F 16A
537000400	COMM.1 POS.1F 16A
537001400	TERMOST.SIC.TRIF. 245°C
539018900	INDICE MAN.C/FRECCIA ROSSA
537001200	STAFF.FISS.COMM.S49 TERMOST.3,5
537000700	TERMOST.F.TRIF. 090-180°C (S)
537000600	TERMOST.F.MONOF.095-182°C GAMB.C
537010100	TELER.20A 600V B.230V 50-60HZ NC
541071300	ASS.SCAT.COMAND.FRIGG.FE-10/15
537007700	MORSETT.6 POLI 40A VITE-FASTON (S)
537014100	SPIA G.B.BIANC.250VAC F.M.
537014200	SPIA G.B.VERDE 250VAC F.M.
537003700	RES.COR.FE-10 2000W 1-230V
537015700	SENSORE MAGNETICO INTERRUTTORE
537015800	UNITA' MAGNETICA SENSORE



FME-2/10  
Tav. 560036400M01P00

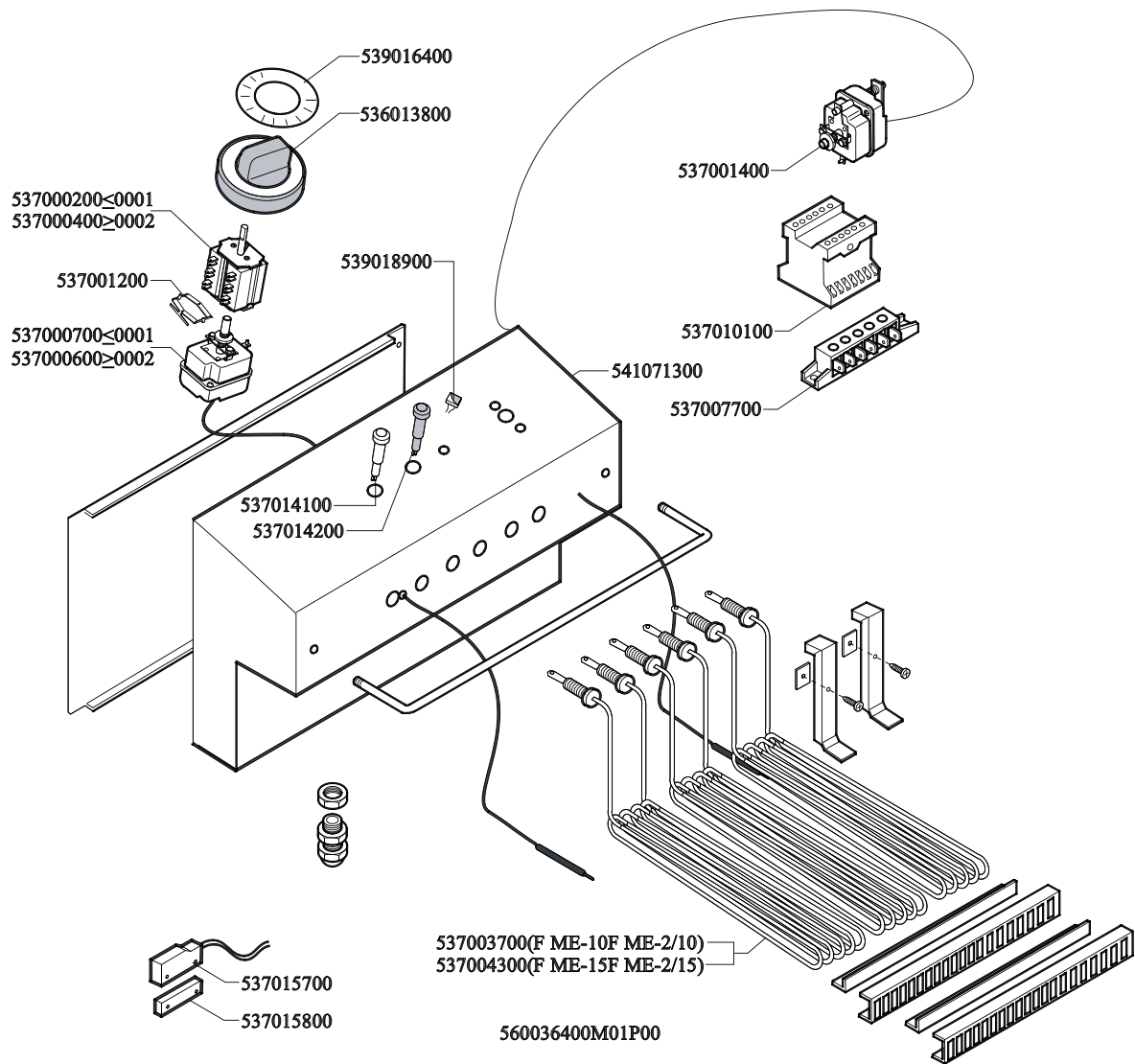



## FME-2/10 - FRIGGITRICI FME-2/10

Codice	Descrizione
536001700	IMPUGNAT.Ø25X19XM6
544005500	COP.VASCA FE/FME-10
531000800	CESTO FG 260X270X110 FE -10
531006200	ASS.FILTRO FE/FME-10
541070700	ASS.PIANO FME-2/10
544111600	FIANCO APP.TOP 700
541053300	ASS.CRUSC.PAST.FMPE-25
533010100	RACC.BIC.Ø18 3/4
533010200	BICONO RUBINETTO 531000100 Ø18
531001000	VALV.SFERA 3/4G F/PORTAG.
541049200	ASS.MOBILE BASE 800
536000200	PARACOLPI Ø12 H.4
541047200	ASS.FILTRO BAC.RACC.OLIO RETT.
541029601	ASS.BAC.RACC.OLIO 40LT
541046500	ASS.PORTA 4 DX
536006400	MANIGLIA S65 NERA
533035200	DIST.MANIGLIA S65 S70
541046600	ASS.PORTA 4 SX
536005200	PIEDE Ø2" 120-180 M10 INOX