

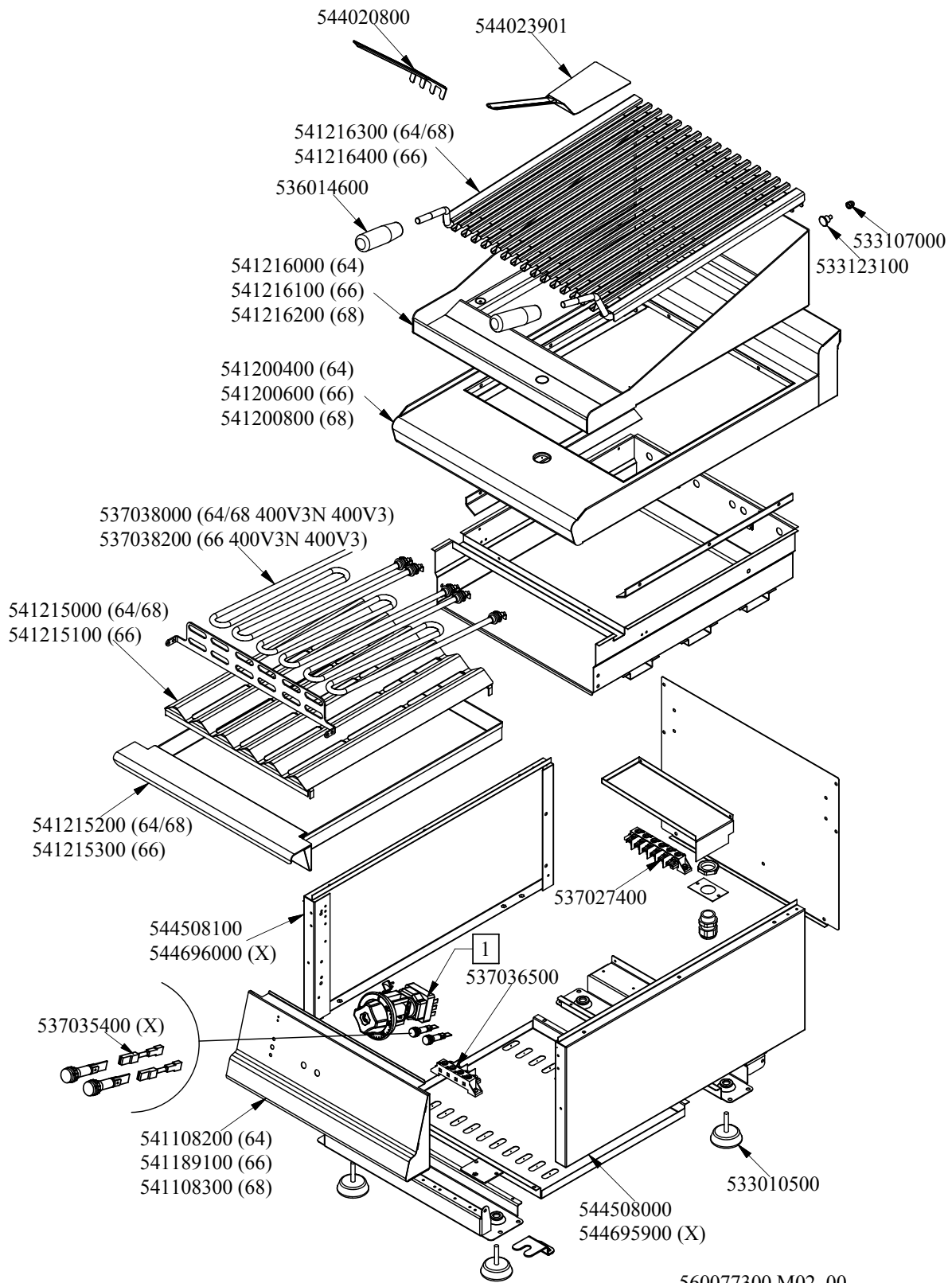

CWT-64ET (SN>=1201<=1604)
 Tav. 560077300 M02_00





CWT-64ET (SN>=1201<=1604) - CUOCIWURSTEL CWT-64ET

Codice	Descrizione
533010500	PIEDE Ø50 017-042 M10 PLAST.
544508000	FIANCO APP.S60T DX
541216300	ASS.GRIGLIA CW-64 TEGOLO S
536014600	IMPUGNAT.Ø28X90XM10 CW
541216000	ASS.PARASP.CWT-64
541200400	ASS.PIANO S60T CWT-64E VEDI 544
537038000	RES.COR.CW-64E 1600W 1-230V
541215000	ASS.RIFLETTENTE CW-64E
541215200	ASS.CASS.RACC.SUGO CWT-64E
541108200	ASS.CRUSC.S607090 CW-74/94E
537027400	MORSETT.6 POLI 40A VITE-VITE
537036500	MORSETT.4 POLI 40A VITE-VITE
544508100	FIANCO APP.S60T SX
544023901	PALETTA FRY-TOP
544020800	RASCHIETTO GRIGLIA CW S70/90
533123100	CODICE IN ELABORAZIONE
533107000	CODICE IN ELABORAZIONE
-	-



COMANDO CW-E FT-E BRF-E (SN<=1604)
Tav. 560100400M00P00

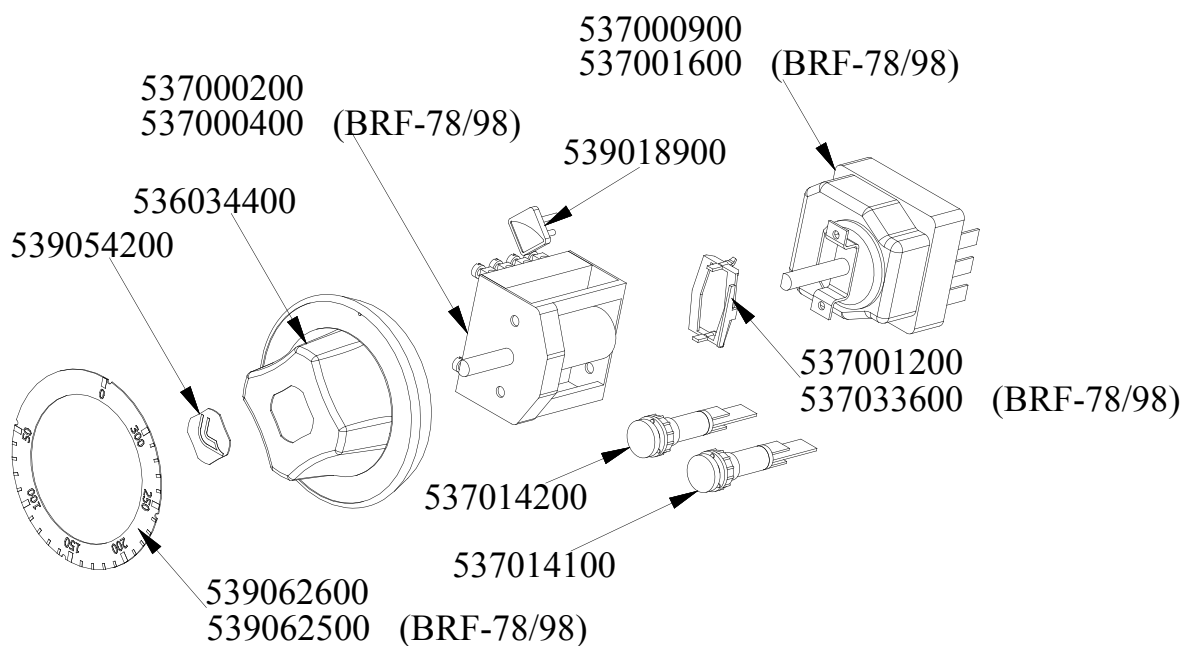

560100400 M00P00



COMANDO CW-E FT-E BRF-E (SN<=1604) - COMPONENTI COMUNI COMANDO_BRF-E

Codice	Descrizione
537000900	TERMOST.F.TRIF. 063-320°C GAMBL
537001600	TERMOST.F.MONOF.055-320°C GAMBL
537000200	COMM.1 POS.3F 16A
537000400	COMM.1 POS.1F 16A
539018900	INDICE MAN.C/FRECCIA ROSSA
536034400	MANOP.Ø77 4 P.Ø06X4,6 NERO C/M
539054200	BOLLINO Ø20,3 CR."L" LOTUS R.
537001200	STAFF.FISS.COMM.S49 TERMOST.3,5
537033600	STAFF.FISS.COMM.S49 TERMOST.8,5
537014200	SPIA G.B.VERDE 250VAC F.M.
537014100	SPIA G.B.BIANC.250VAC F.M.
539062600	DISC.72.FT-ET R. (050,300°)
539062500	DISC.72.FT-EM R. (050,300°)