

Fig.10-1 Disegno esploso

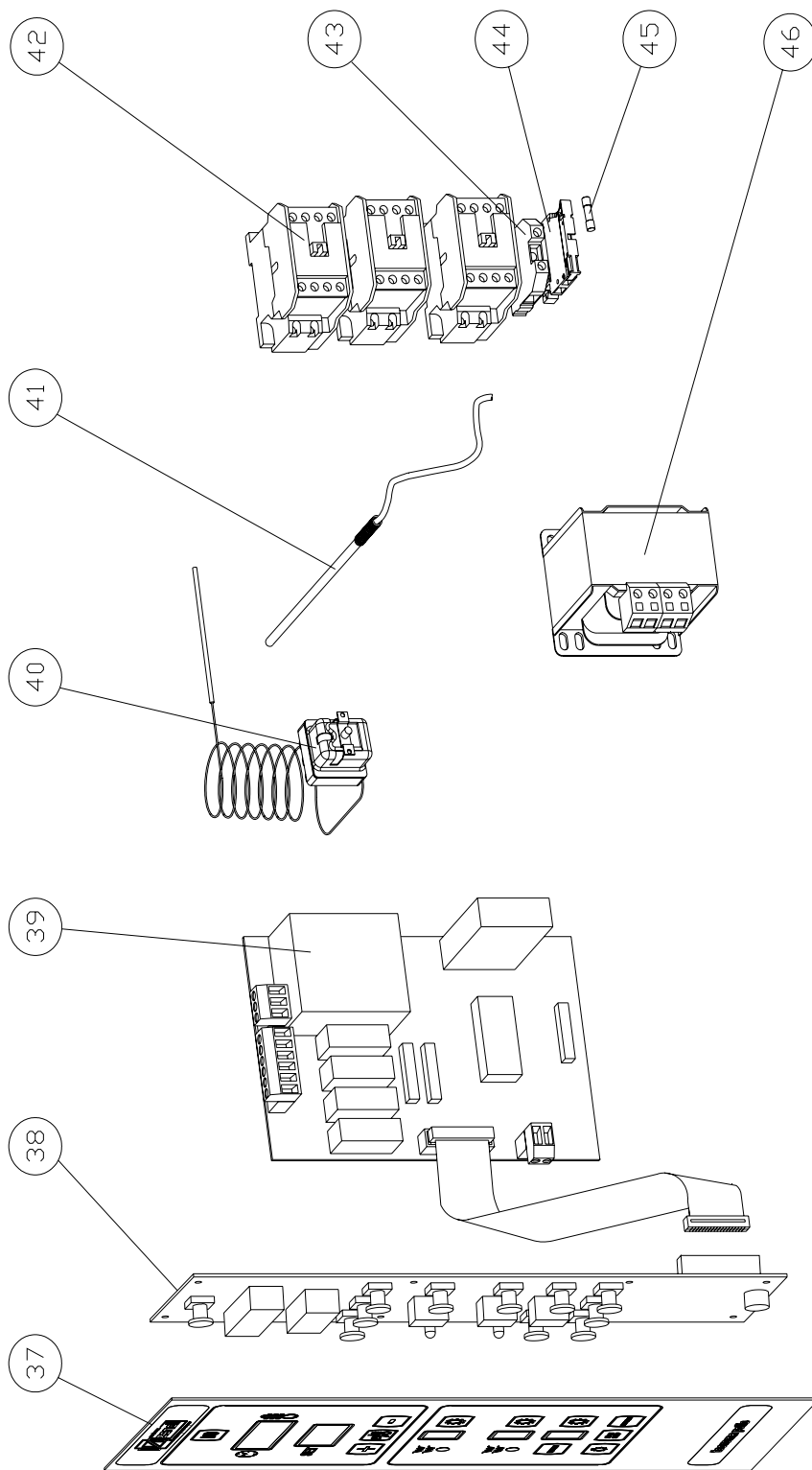

Fig.10-2 Disegno esploso parti elettriche

| N° | Descrizione | Codici | | | | |
|----|--------------------------------|---------------|----------------|---------------|---------------|---------------|
| | | T2 POLIS MC18 | T2S POLIS MC18 | T3 POLIS MC18 | T4 POLIS MC18 | T6 POLIS MC18 |
| 1 | TELAIO FERMA VETRO | CARP0110 | CARP0545 | CARP0111 | CARP0110 | CARP0111 |
| 2 | STAFFA SX | SUPP0206 | SUPP0206 | SUPP0206 | SUPP0206 | SUPP0206 |
| 3 | BOCCOLA | BOCC0006 | BOCC0006 | BOCC0006 | BOCC0006 | BOCC0006 |
| 4 | TELAIO PORTA | PORT0162 | PORT0183 | PORT0164 | PORT0162 | PORT0164 |
| 5 | STAFFA DX | SUPP0207 | SUPP0207 | SUPP0207 | SUPP0207 | SUPP0207 |
| 6 | RESISTENZA ANTERIORE | RESI0068 | RESI0035 | RESI0069 | RESI0068 | RESI0069 |
| 7 | RESISTENZA POSTERIORE | RESI0051 | RESI0035 | RESI0052 | RESI0051 | RESI0052 |
| 8 | POMELLO SCARICO VAPORE | MANI0009 | MANI0009 | MANI0009 | MANI0009 | MANI0009 |
| 9 | PORTALE | FIAN0149 | FIAN0232 | FIAN0151 | FIAN0149 | FIAN0151 |
| 10 | LAMIERA DI CONTENIMENTO | CARP0486 | CARP1096 | CARP0486 | CARP0488 | CARP0488 |
| 11 | FIANCO SX | FIAN0228 | FIAN0235 | FIAN0228 | FIAN0230 | FIAN0230 |
| 12 | FONDO-CIELO | CARP0506 | CARP1098 | CARP0507 | CARP0508 | CARP0509 |
| 13 | ASTA FARFALLA | ASTA0007 | ASTA0013 | ASTA0007 | ASTA0015 | ASTA0015 |
| 14 | REGISTRO COMANDO FARFALLA | CARP0248 | CARP0248 | CARP0248 | CARP0248 | CARP0248 |
| 15 | CAMERA COTTURA | CAME0081 | CAME0090 | CAME0082 | CAME0115 | CAME0117 |
| 16 | SCHIENALE | FIAN0153 | FIAN0233 | FIAN0155 | FIAN0153 | FIAN0155 |
| 17 | CAMINO | TUBO0046 | TUBO0046 | TUBO0046 | TUBO0046 | TUBO0046 |
| 18 | CRISTALLO PORTA | CRIS0025 | CRIS0026 | CRIS0028 | CRIS0025 | CRIS0028 |
| 19 | TUBO MANIGLIA | MANI0057 | MANI0060 | MANI0058 | MANI0057 | MANI0058 |
| 20 | MOLLA PORTA SX | SPRI0009 | SPRI0009 | SPRI0009 | SPRI0009 | SPRI0009 |
| 21 | MOLLA PORTA DX | SPRI0010 | SPRI0010 | SPRI0010 | SPRI0010 | SPRI0010 |
| 22 | REFRATTARIO COTTURA | REFR0023 | REFR0022 | REFR0023 | REFR0024 | REFR0024 |
| 23 | PIANO COTTURA IN LAMIERA ANT. | PLAM0018 | PLAM0024 | PLAM0020 | PLAM0018 | PLAM0020 |
| 24 | PIANO COTTURA IN LAMIERA POST. | PLAM0019 | PLAM0025 | PLAM0021 | PLAM0019 | PLAM0021 |
| 25 | RINFORZO REFRATTARI | - | - | - | CARP1208 | CARP1209 |
| 26 | CARTER COMANDI | CART0128 | CART0128 | CART0128 | CART0128 | CART0128 |
| 27 | TELAIO VETRO VANO LUCE | CARP0046 | CARP0046 | CARP0046 | CARP0046 | CARP0046 |
| 28 | CRISTALLO LUCE | CRIS0006 | CRIS0006 | CRIS0006 | CRIS0006 | CRIS0006 |
| 29 | LAMIERA DI SEPARAZIONE | CARP0491 | CARP1097 | CARP0491 | CARP1316 | CARP1316 |
| 30 | FONDO-CIELO | CARP0506 | CARP1098 | CARP0507 | CARP0508 | CARP0509 |
| 31 | SUPPORTO LAMPADA ALOGENA | CARP0515 | CARP0515 | CARP0515 | CARP0515 | CARP0515 |
| 32 | LAMPADA ALOGENA | LAMP0020 | LAMP0020 | LAMP0020 | LAMP0020 | LAMP0020 |
| 33 | PORTALAMPADA BISPINA | LAMP0021 | LAMP0021 | LAMP0021 | LAMP0021 | LAMP0021 |
| 34 | STAFFA SUPPORTO PORTALAMPADA | CARP1275 | CARP1275 | CARP1275 | CARP1275 | CARP1275 |
| 35 | COLLETTORE LUCE LAMPADA | CARP0495 | CARP1130 | CARP0495 | CARP0495 | CARP0495 |
| 36 | FIANCO DX | FIAN0224 | FIAN0234 | FIAN0224 | FIAN0226 | FIAN0226 |
| 37 | MEMBRANA ADESIVA | PANN0275 | PANN0275 | PANN0275 | PANN0275 | PANN0275 |
| 38 | PULSANTIERA 9 PROGRAMMI | ELET0149 | ELET0149 | ELET0149 | ELET0149 | ELET0149 |
| 39 | SCHEDA BASE | ELET0148 | ELET0148 | ELET0148 | ELET0148 | ELET0148 |
| 40 | TERMOSTATO SICUREZZA 500°C | TERM0005 | TERM0005 | TERM0005 | TERM0005 | TERM0005 |
| 41 | SONDA FE-COST 6x200 | TERM0020 | TERM0020 | TERM0020 | TERM0020 | TERM0020 |
| 42 | TELERUTTORE 32 A | ELET0002 | ELET0002 | ELET0002 | ELET0002 | ELET0002 |
| | | ELET0160 | ELET0160 | ELET0160 | ELET0160 | ELET0160 |
| | | ELET0432 | ELET0432 | ELET0432 | ELET0432 | ELET0432 |
| 43 | MORSETTO DI TERRA 10 MMQ | ELET0462 | ELET0462 | ELET0462 | ELET0462 | ELET0462 |
| 44 | MORSETTO PORTAFUSIBILE 4 MMQ | ELET0440 | ELET0440 | ELET0440 | ELET0440 | ELET0440 |
| 45 | FUSIBILE | ELET0204 | ELET0204 | ELET0204 | ELET0204 | ELET0204 |
| 46 | TRASFORMATORE LAMPADA ALOGENA | ELET0144 | ELET0144 | ELET0144 | ELET0144 | ELET0144 |

Tab.10.1 Elenco parti di ricambio

| N° | Descrizione | Codici | | | |
|----|--------------------------------|---------------|---------------|---------------|---------------|
| | | T2 POLIS MC28 | T3 POLIS MC28 | T4 POLIS MC28 | T6 POLIS MC28 |
| 1 | TELAIO FERMA VETRO | CARP0110 | CARP0111 | CARP0110 | CARP0111 |
| 2 | STAFFA SX | SUPP6013 | SUPP6013 | SUPP6013 | SUPP6013 |
| 3 | BOCCOLA | BOCC0006 | BOCC0006 | BOCC0006 | BOCC0006 |
| 4 | TELAIO PORTA | PORT6035 | PORT6036 | PORT6035 | PORT6036 |
| 5 | STAFFA DX | SUPP6014 | SUPP6014 | SUPP6014 | SUPP6014 |
| 6 | RESISTENZA ANTERIORE | RESI0068 | RESI0069 | RESI0068 | RESI0069 |
| 7 | RESISTENZA POSTERIORE | RESI0051 | RESI0052 | RESI0051 | RESI0052 |
| 8 | POMELLO SCARICO VAPORE | MANI0009 | MANI0009 | MANI0009 | MANI0009 |
| 9 | PORTALE | FIAN0207 | FIAN0208 | FIAN0207 | FIAN0208 |
| 10 | LAMIERA DI CONTENIMENTO | CARP0774 | CARP0774 | CARP0773 | CARP0773 |
| 11 | FIANCO SX | FIAN0229 | FIAN0229 | FIAN0231 | FIAN0231 |
| 12 | FONDO-CIELO | CARP0506 | CARP0507 | CARP0508 | CARP0509 |
| 13 | ASTA FARFALLA | ASTA0007 | ASTA0007 | ASTA0015 | ASTA0015 |
| 14 | REGISTRO COMANDO FARFALLA | CARP0248 | CARP0248 | CARP0248 | CARP0248 |
| 15 | CAMERA COTTURA | CAME0085 | CAME0086 | CAME0116 | CAME0118 |
| 16 | SCHIENALE | FIAN0209 | FIAN0210 | FIAN0209 | FIAN0210 |
| 17 | CAMINO | TUBO0075 | TUBO0075 | TUBO0075 | TUBO0075 |
| 18 | CRISTALLO PORTA | CRIS0025 | CRIS0028 | CRIS0025 | CRIS0028 |
| 19 | TUBO MANIGLIA | MANI0057 | MANI0058 | MANI0057 | MANI0058 |
| 20 | MOLLA PORTA SX | SPRI0009 | SPRI0009 | SPRI0009 | SPRI0009 |
| 21 | MOLLA PORTA DX | SPRI0010 | SPRI0010 | SPRI0010 | SPRI0010 |
| 22 | REFRATTARIO COTTURA | REFR0023 | REFR0023 | REFR0024 | REFR0024 |
| 23 | PIANO COTTURA IN LAMIERA ANT. | PLAM0018 | PLAM0020 | PLAM0018 | PLAM0020 |
| 24 | PIANO COTTURA IN LAMIERA POST. | PLAM0019 | PLAM0021 | PLAM0019 | PLAM0021 |
| 25 | RINFORZO REFRATTARI | - | - | CARP1208 | CARP1209 |
| 26 | CARTER COMANDI | CART0129 | CART0129 | CART0129 | CART0129 |
| 27 | TELAIO VETRO VANO LUCE | CARP0046 | CARP0046 | CARP0046 | CARP0046 |
| 28 | CRISTALLO LUCE | CRIS0006 | CRIS0006 | CRIS0006 | CRIS0006 |
| 29 | LAMIERA DI SEPARAZIONE | CARP0771 | CARP0771 | CARP1317 | CARP1317 |
| 30 | FONDO-CIELO | CARP0506 | CARP0507 | CARP0508 | CARP0509 |
| 31 | SUPPORTO LAMPADA ALOGENA | CARP0515 | CARP0515 | CARP0515 | CARP0515 |
| 32 | LAMPADA ALOGENA | LAMP0020 | LAMP0020 | LAMP0020 | LAMP0020 |
| 33 | PORTALAMPADA BISPINA | LAMP0021 | LAMP0021 | LAMP0021 | LAMP0021 |
| 34 | STAFFA SUPPORTO PORTALAMPADA | CARP1275 | CARP1275 | CARP1275 | CARP1275 |
| 35 | COLLETTORE LUCE LAMPADA | CARP0495 | CARP0495 | CARP0495 | CARP0495 |
| 36 | FIANCO DX | FIAN0225 | FIAN0225 | FIAN0227 | FIAN0227 |
| 37 | MEMBRANA ADESIVA | PANN0275 | PANN0275 | PANN0275 | PANN0275 |
| 38 | PULSANTIERA 9 PROGRAMMI | ELET0149 | ELET0149 | ELET0149 | ELET0149 |
| 39 | SCHEDA BASE | ELET0148 | ELET0148 | ELET0148 | ELET0148 |
| 40 | TERMOSTATO SICUREZZA 500°C | TERM0005 | TERM0005 | TERM0005 | TERM0005 |
| 41 | SONDA FE-COST 6x200 | TERM0020 | TERM0020 | TERM0020 | TERM0020 |
| 42 | TELERUTTORE 32 A | ELET0002 | ELET0002 | ELET0002 | ELET0002 |
| | | ELET0160 | ELET0160 | ELET0160 | ELET0160 |
| | | ELET0432 | ELET0432 | ELET0432 | ELET0432 |
| 43 | MORSETTO DI TERRA 10 MMQ | ELET0462 | ELET0462 | ELET0462 | ELET0462 |
| 44 | MORSETTO PORTAFUSIBILE 4 MMQ | ELET0440 | ELET0440 | ELET0440 | ELET0440 |
| 45 | FUSIBILE | ELET0204 | ELET0204 | ELET0204 | ELET0204 |
| 46 | TRASFORMATORE LAMPADA ALOGENA | ELET0144 | ELET0144 | ELET0144 | ELET0144 |

Tab.10.2 Elenco parti di ricambio